



## Notice of road closure, Boddington and Wormleighton

January 2023 | [www.hs2.org.uk](http://www.hs2.org.uk)

High Speed Two (HS2) is the new high speed railway for Britain. We are following Government and Public Health England (PHE) advice on working safely during the pandemic. The health and safety of our workforce and the communities we work within is our priority. You can sign up for regular updates in your local area at [www.hs2inyourarea.co.uk](http://www.hs2inyourarea.co.uk).

### What are we doing?

As we prepare for the construction of the Banbury Road Overbridge, it is necessary to remove vegetation from the roadside, in the areas where new roads will be built.

By carrying out this work in the winter we will minimise the risks of disturbing nesting birds. Prior to any vegetation removal, an ecologist will complete a detailed survey of the area to be cleared. Any protected species found to be present will be recorded and the vegetation will be left undisturbed with the appropriate buffer zone established.

For the safety of road users and our staff, a section of Banbury Road in Boddington will be closed during off-peak hours for approximately 1 week for this vegetation removal to take place. Depending on the weather and ground conditions, we may make rapid progress and so we may be able to open the road much earlier than planned.

Prior to the above closure, we will also be carrying out some localised vegetation clearance along Wormleighton Road. While these works are carried out, there will two-way traffic lights installed for approximately for 1 week.

### When will these works take place?

Temporary traffic lights will be in operation on Wormleighton Road between 8am and 4pm from Monday 6 February to Sunday 12 February 2023.

A section of Banbury Road will be closed from 8am to 6pm, from Monday 13 February to Sunday 19 February 2023 with a diversion in place. This is expected to be the maximum duration and the road may open earlier.

**If you have a question about HS2 or our works, please contact our HS2 Helpdesk team on 08081 434 434**

### Duration of works

Wormleighton Road will have temporary traffic lights in operation from 6 to 12 February 2023.

Banbury Road will be closed during the day from 13 to 19 February 2023.

Normal Working hours:

Monday to Friday:

8am to 6pm

Saturday & Sunday:

8am to 6pm

Our contractors may be on site for one hour's start-up and shutdown either side of these times.

### What to expect

Varied activities with both quiet and busier periods.

Noise from equipment used for the works.

Localised vegetation clearance to facilitate upcoming works.

### What we will do

Manage any environmental impacts, such as traffic and noise.

Respond promptly to any complaints and take appropriate action.

Take care to respect the community.

# Notice of road closure, Boddington and Wormleighton

Notification



[www.hs2.org.uk](http://www.hs2.org.uk)

## Where will the works take place?

The map below, shows the section of Wormleighton Road that will be closed from Monday 6 February to Sunday 12 February 2023.

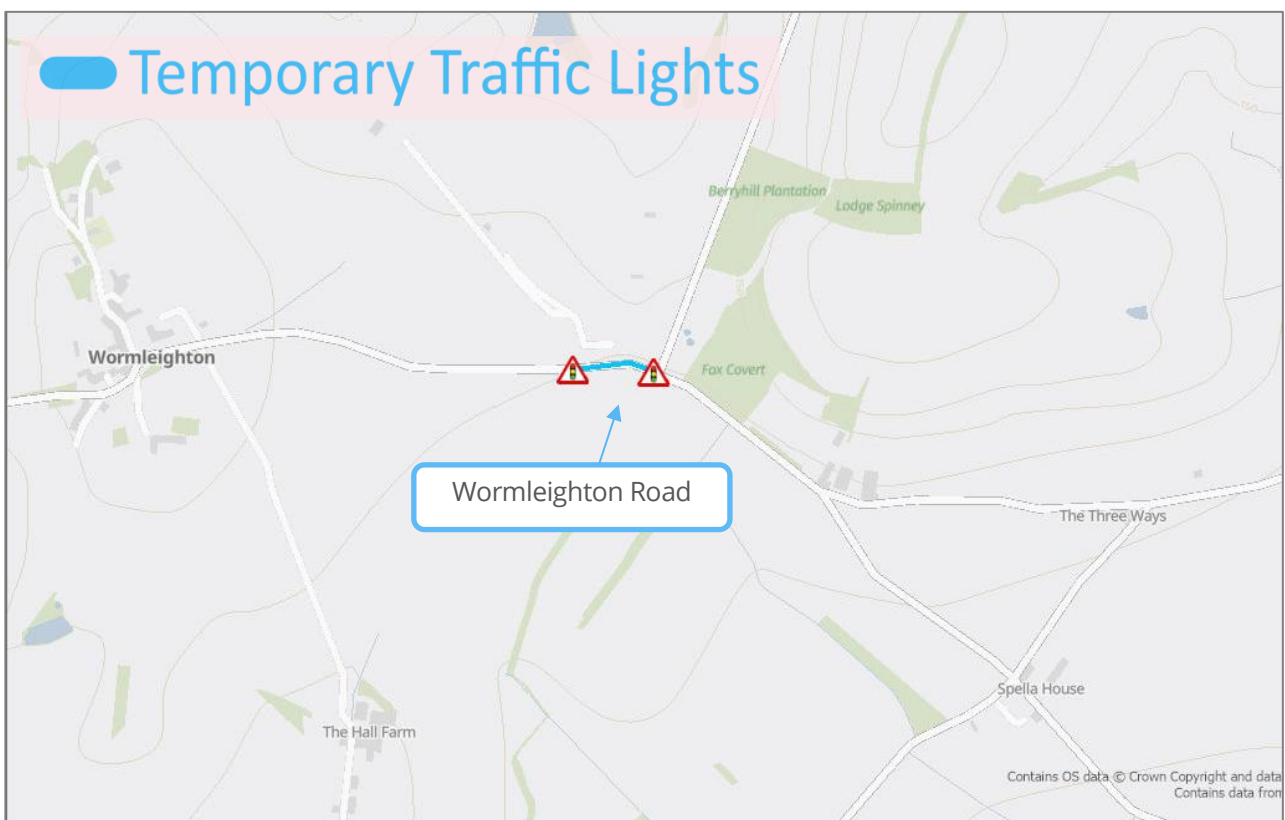

Contact our HS2 Helpdesk team on **08081 434 434**

# Notice of road closure, Boddington and Wormleighton

Notification



[www.hs2.org.uk](http://www.hs2.org.uk)

## Where will the works take place?

The map below, shows the section of Banbury Road that will be closed from Monday 13 February to Sunday 19 February 2023 with a diversion in place. Depending on the weather and ground conditions, we may make rapid progress and so we may be able to open the road much earlier than planned.

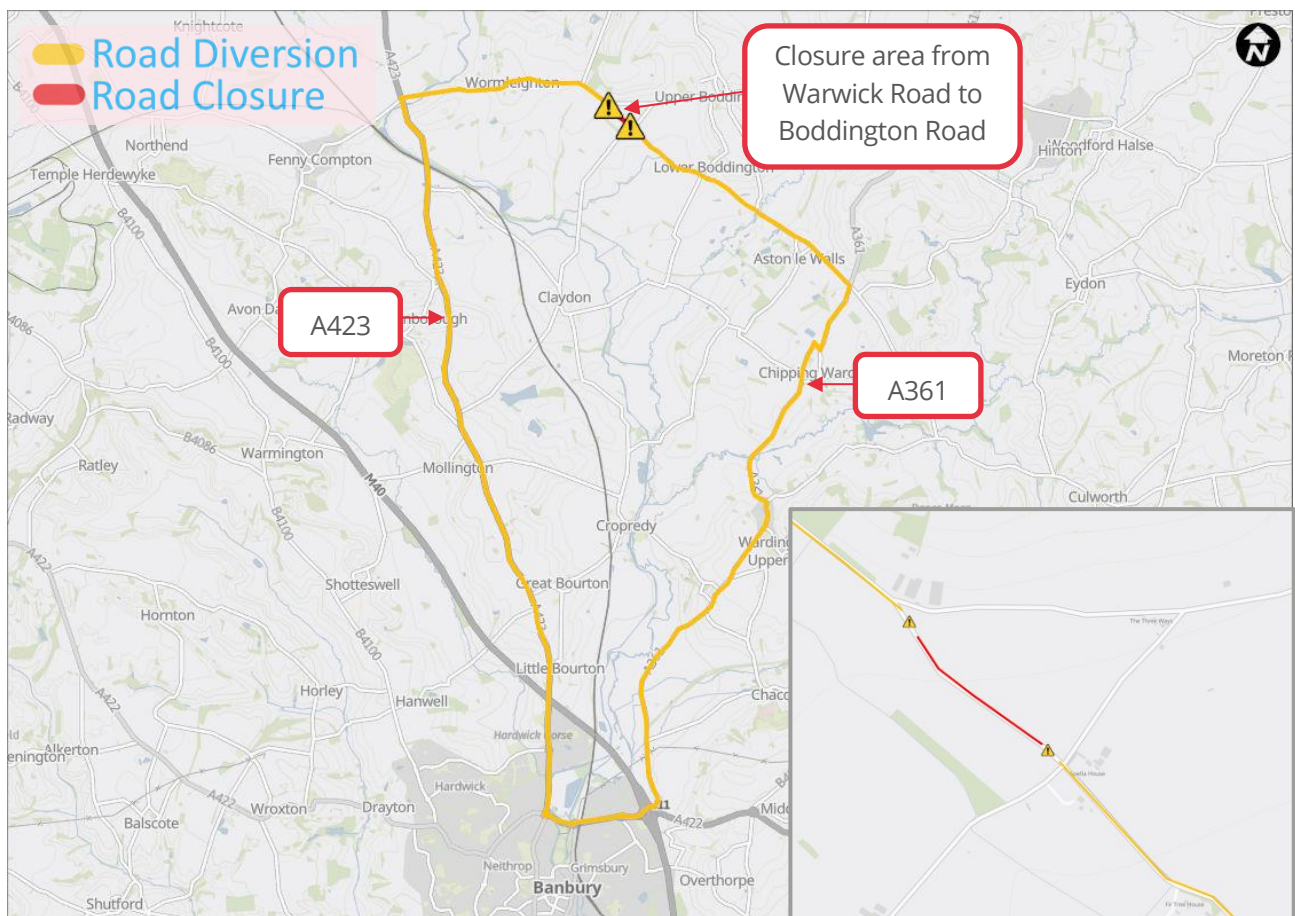

Contact our HS2 Helpdesk team on **08081 434 434**

# Keeping you informed

We are committed to keeping you informed about work on HS2. This includes ensuring you know what to expect and when to expect it, as well as how we can help.

## Residents' Charter and Commissioner

The Residents' Charter is our promise to communicate as clearly as we possibly can with people who live along or near the HS2 route. [www.gov.uk/government/publications/hs2-residents-charter](http://www.gov.uk/government/publications/hs2-residents-charter)

We also have an independent Residents' Commissioner whose job is to make sure we keep to the promises we make in the Charter and to keep it under constant review. Find reports at: [www.gov.uk/government/collections/hs2-ltd-residents-commissioner](http://www.gov.uk/government/collections/hs2-ltd-residents-commissioner)

You can contact the Commissioner at: [residentscommissioner@hs2.org.uk](mailto:residentscommissioner@hs2.org.uk)

## Construction Commissioner

The Construction Commissioner's role is to mediate and monitor the way in which HS2 Ltd manages and responds to construction complaints. You can contact the Construction Commissioner by emailing: [complaints@hs2-cc.org.uk](mailto:complaints@hs2-cc.org.uk)

## Property and compensation

You can find out all about HS2 and properties along the line of route by visiting: [www.gov.uk/government/collections/hs2-property](http://www.gov.uk/government/collections/hs2-property)  
Find out if you're eligible for compensation at: [www.gov.uk/claim-compensation-if-affected-by-hs2](http://www.gov.uk/claim-compensation-if-affected-by-hs2)

## Holding us to account

If you are unhappy for any reason you can make a complaint by contacting our HS2 Helpdesk team. For more details on our complaints process, please visit our website: [www.hs2.org.uk/how-to-complain](http://www.hs2.org.uk/how-to-complain)

## Contact Us

Contact our HS2 Helpdesk team all day, every day of the year on:

 Freephone **08081 434 434**

 Minicom **08081 456 472**

 Email **[hs2enquiries@hs2.org.uk](mailto:hs2enquiries@hs2.org.uk)**

Write to:

**FREEPOST**

**HS2 Community Engagement**

Website **[www.hs2.org.uk](http://www.hs2.org.uk)**

To keep up to date with what is happening in your local area, visit: **[www.hs2inyourarea.co.uk](http://www.hs2inyourarea.co.uk)**

**Please contact us if you'd like a free copy of this document in large print, Braille, audio or easy read. You can also contact us for help and information in a different language.**

HS2 Ltd is committed to protecting personal information. If you wish to know more about how we use your personal information please see our Privacy Notice <https://www.gov.uk/government/publications/high-speed-two-ltd-privacy-notice>

**Reference number:** HS2-MW-EK-Ph1-Ar-Ce-C1-Prog-works-11-01/11/2023

High Speed Two (HS2) Limited, registered in England and Wales.  
Registered office: Two Snowhill, Snow Hill Queensway, Birmingham B4 6GA.  
Company registration number: 06791686. VAT registration number: 888 8512 56.